

KEARNY MESA - DUNN BUSINESS PARK UNIT NO. 1

GENERAL NOTES

1. NEITHER THE OWNER, NOR THE ENGINEER OF WORK WILL ENFORCE SAFETY MEASURES OR REGULATIONS. THE CONTRACTOR SHALL DESIGN, CONSTRUCT AND MAINTAIN ALL SAFETY DEVICES, INCLUDING SHORING, AND SHALL BE SOLELY RESPONSIBLE FOR CONFORMING TO ALL LOCAL, STATE AND FEDERAL SAFETY AND HEALTH STANDARDS, LAWS AND REGULATIONS.
2. ALL CONTOURS ARE 2' INTERVALS.
3. ALL SLOPE BANKS ARE 2:1 UNLESS OTHERWISE NOTED.

UNDERGROUND FACILITIES

1. PRECISE LOCATION AND ELEVATIONS ARE NOT KNOWN FOR THE EXISTING UNDERGROUND UTILITIES. CONTRACTOR SHALL MAKE SUFFICIENT EXPLORATIONS TO LOCATE EXISTING UTILITIES BEFORE COMMENCING CONSTRUCTION AND SHALL NOTIFY THE ENGINEER OF WORK OF ANY POTENTIAL CONFLICTS. CONTRACTOR SHALL BE RESPONSIBLE FOR THE PROTECTION OF EXISTING UTILITIES.
2. THE EXISTENCE AND LOCATION OF ANY UNDERGROUND UTILITY PIPE OR STRUCTURE SHOWN ON THESE PLANS WERE OBTAINED BY A SEARCH OF THE AVAILABLE RECORDS. TO THE BEST OF OUR KNOWLEDGE THERE ARE NO OTHER EXISTING UTILITIES EXCEPT AS SHOWN ON THESE PLANS.
3. CONTRACTOR SHALL NOTIFY THE SAN DIEGO GAS & ELECTRIC COMPANY PRIOR TO STARTING WORK NEAR COMPANY FACILITIES AND SHALL COORDINATE HIS WORK WITH COMPANY REPRESENTATIVES.
4. CONTRACTOR SHALL NOTIFY THE PACIFIC TELEPHONE COMPANY PRIOR TO STARTING WORK NEAR COMPANY FACILITIES AND SHALL COORDINATE HIS WORK WITH COMPANY REPRESENTATIVES.
5. BEFORE EXCAVATING FOR THIS CONTRACT, VERIFY LOCATION OF UNDERGROUND UTILITIES. CONTRACTOR SHALL TELEPHONE FOR:
 - SAN DIEGO GAS & ELECTRIC CO: 235-6323
 - PACIFIC TELEPHONE COMPANY: 293-0895

SITE GRADING SPECIFICATIONS

1. ALL GRADING SHALL BE DONE UNDER THE OBSERVATION OF A QUALIFIED SOILS ENGINEER. ALL AREAS TO BE FILLED SHALL BE PREPARED TO BE FILLED AND FILL SHALL BE PLACED IN ACCORDANCE WITH THE FOUNDATION SOILS INVESTIGATION FOR KEARNY MESA BUSINESS PARK, JOB NO. 77-156-1, DATED MAY 11, 1977, AND PREPARED BY REINER & ASSOCIATES. THIS REPORT AND ALL SUBSEQUENT ADDENDUMS SHOULD BE REVIEWED BY THE CONTRACTOR.
- IT SHALL BE THE CONTRACTOR'S RESPONSIBILITY TO PLACE, SPREAD, WATER AND COMPACT THE FILL IN STRICT ACCORDANCE WITH THESE SPECIFICATIONS. A SOILS ENGINEER SHALL BE THE OWNER'S REPRESENTATIVE TO INSPECT THE CONSTRUCTION OF FILLS. EXCAVATION AND THE PLACEMENT OF FILL SHALL BE UNDER THE DIRECT INSPECTION OF THE SOILS ENGINEER, AND HE SHALL GIVE WRITTEN NOTICE OF CONFORMANCE WITH THE SPECIFICATIONS UPON COMPLETION OF GRADING. DEVIATIONS FROM THESE SPECIFICATIONS WILL BE PERMITTED ONLY UPON WRITTEN AUTHORIZATION FROM THE SOILS ENGINEER.
2. OBSERVATIONS AND COMPACTION TESTS SHALL BE MADE BY THE SOILS ENGINEER DURING THE FILLING AND COMPACTING OPERATIONS SO THAT HE CAN STATE HIS OPINION THAT THE FILL WAS CONSTRUCTED IN ACCORDANCE WITH THE SPECIFICATIONS.
3. CONTRACTOR SHALL TAKE THE NECESSARY PRECAUTIONS REQUIRED TO PROTECT ADJACENT PROPERTIES DURING THE GRADING OPERATIONS.
4. DURING CONSTRUCTION, THE CONTRACTOR SHALL PROPERLY GRADE ALL EXCAVATED SURFACES TO PROVIDE POSITIVE DRAINAGE AND PREVENT PONDING OF WATER. HE SHALL CONTROL SURFACE WATER TO AVOID DAMAGE TO ADJACENT PROPERTIES OR THE FINISHED WORK ON THE SITE. THE CONTRACTOR SHALL TAKE REMEDIAL MEASURES TO PREVENT EROSION OF FRESHLY GRADED AREAS AND UNTIL SUCH TIME AS PERMANENT DRAINAGE AND EROSION CONTROL MEASURES HAVE BEEN INSTALLED.
- AFTER COMPLETION, AFTER GRADING IS COMPLETED AND THE SOILS ENGINEER HAS FINISHED HIS OBSERVATIONS OF THE WORK, NO FURTHER EXCAVATION OR FILLING SHALL BE DONE EXCEPT UNDER THE OBSERVATION OF THE SOILS ENGINEER.
5. CUT AND FILL SLOPES SHALL BE CUT AND TRIMMED TO THE FINISH GRADE TO PRODUCE SMOOTH SURFACES AND UNIFORM CROSS SECTIONS. THE SLOPES OF EXCAVATIONS AND EMBANKMENTS SHALL BE SHAVED, PLANTED AND TRIMMED AS DIRECTED BY THE ENGINEER OF WORK AND LEFT IN A NEAT AND ORDERLY CONDITION. ALL STONES, ROOTS, OR OTHER WASTE MATTER EXPOSED ON EXCAVATION OR EMBANKMENT SLOPES WHICH ARE LIABLE TO BECOME LOOSEED SHALL BE REMOVED AND DISPOSED OF.
6. WHERE TRENCHES ARE ADJACENT TO FUTURE BUILDING SITES, SOILS REPORTS SHALL BE SUBMITTED TO THE ENGINEER OF WORK BY A QUALIFIED SOILS ENGINEER WHICH CERTIFY THAT TRENCH BACKFILL WAS COMPACTED AS DIRECTED BY THE SOILS ENGINEER IN ACCORDANCE WITH THE ON-SITE EARTHWORK SPECIFICATIONS.
7. ALL TREES, BRUSH, GRASS, AND OTHER OBJECTIONABLE MATERIAL WITHIN THE AREA TO BE GRADED SHALL BE COLLECTED AND DISPOSED OFF-SITE BY THE CONTRACTOR, SO AS TO LEAVE THE AREAS THAT HAVE BEEN CLEARED WITH A NEAT AND FINISHED APPEARANCE FREE FROM UNDESIRABLE DEBRIS. BRUSH SHALL BE REMOVED ONLY WITHIN THE AREA TO BE GRADED.
8. THE ELEVATIONS SHOWN ON THE PLANS REPRESENT THE FINISH SURFACE ELEVATIONS OF ROADS, PAVEMENTS, WALKS, AND LANDSCAPED AREAS. THE CONTRACTOR SHALL MAKE ALLOWANCES FOR THE THICKNESS OF PAVING MATERIALS, FLATWORK, AND TOPSOIL.
9. GRADING SHALL BE DONE WITHIN A TOLERANCE OF $\pm 0.1'$ OF THE GRADES AND ELEVATIONS SHOWN ON THESE PLANS AND ALL SLOPES SHALL BE CONSTRUCTED WITHIN 0.5% OF THE LOCATION SHOWN ON THE PLANS. IN NO WAY DO THE ABOVE TOLERANCES RELIEVE THE CONTRACTOR OF THE RESPONSIBILITY OF PROVIDING A FINISH SURFACE THAT WILL NOT FLOOD.
10. ALL RAVINES, GULLIES, AND WASHES HAVING ALLUVIAL MATERIAL SHALL BE CLEARED AND RECOMPACTED AT THE DIRECTION OF THE SOILS ENGINEER.
11. ALL AREAS TO RECEIVE FILL SHALL BE RIPPED AND RECOMPACTED TO A DEPTH OF 1.0 FEET, PRIOR TO PLACING FILL.
12. ALL TRANSITION PADS SHALL BE UNDERCUT TO A DEPTH OF 1.5 FEET, OR TO A DEPTH ADEQUATE TO MINIMIZE DIFFERENTIAL SETTLEMENT TO WITHIN REASONABLE TOLERANCE.
13. CUT AND FILL SLOPES SHALL BE NO STEEPER THAN 1:1. ALL NATURAL SLOPES, STEEPER THAN 3:1 SHALL BE KEPT AND REACHED AT THE DIRECTION OF THE SOILS ENGINEER.
14. THE MAXIMUM DENSITY SHALL BE DETERMINED IN ACCORDANCE WITH ASTM: D-1557-70.
15. ALL REMOVED AND FILL MATERIAL SHALL BE PLACED AT OR ABOVE OPTIMUM MOISTURE, AND COMPACTED TO 90 PERCENT OF MAXIMUM DENSITY.
16. ALL IMPORTED SOILS OR BORROW PIT MATERIAL SHALL BE APPROVED BY THE SOILS ENGINEER PRIOR TO IMPORTING OR PLACING.
17. ALL UTILITY TRENCHES SHALL BE COMPACTED TO 90 PERCENT OF MAXIMUM DENSITY OR BACKFILLED WITH A CLEAN SAND WITH A SAND EQUIVALENT IN EXCESS OF 70. THE SAND WITH AN S.E. OF 30 MAY BE FLOODED OR JETTED FOR COMPACTION.

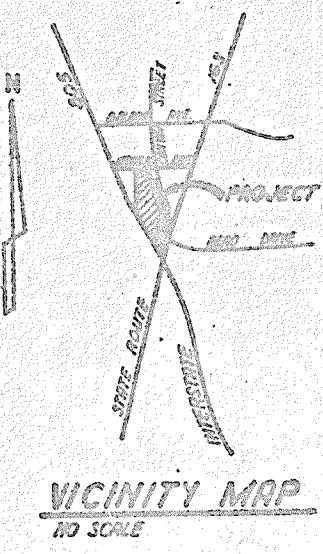
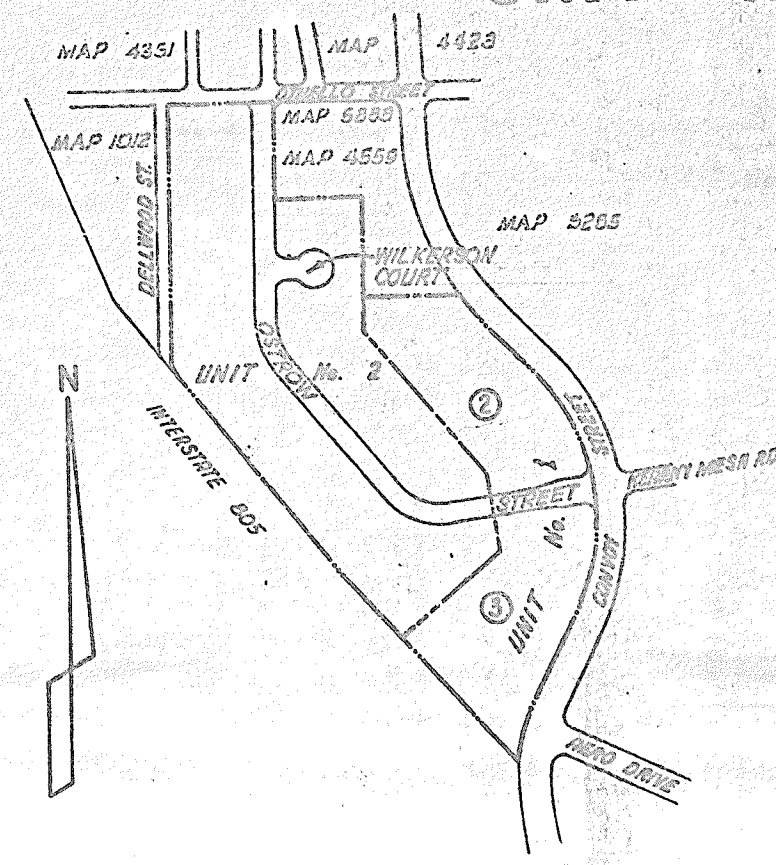

NOTE

CONTRACTOR TO OBTAIN SPECIFICATIONS FROM
CITY OF SAN DIEGO - DOCUMENT 74-6595
LANDSCAPE TO BE INSTALLED PER SPEC

WORK TO BE DONE

THE IMPROVEMENTS CONSIST OF THE FOLLOWING WORK TO BE DONE ACCORDING TO THESE PLANS AND THE FOLLOWING SPECIFICATIONS AND STANDARD DRAWINGS OF THE CITY OF SAN DIEGO.
SPECIFICATIONS - GREEN BOOK STANDARD SPECIFICATIONS (1976 EDITION), DOCUMENT NO. 755163, FILED MAY 10, 1976
CITY OF SAN DIEGO SUPPLEMENT TO GREEN BOOK STANDARD SPECIFICATIONS FOR USE WITH SUBDIVISIONS AND PUBLIC IMPROVEMENT PERMITS (DATED NOVEMBER 24, 1976) ON FILE IN THE CITY ENGINEER'S OFFICE
STANDARD DRAWINGS - REGIONAL STANDARD DRAWINGS (DECEMBER, 1975 EDITION), DOCUMENT NO. 755715, FILED JUNE 25, 1976

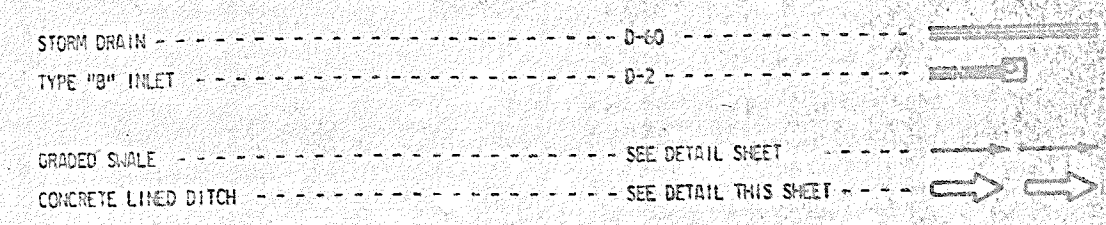

LEGEND

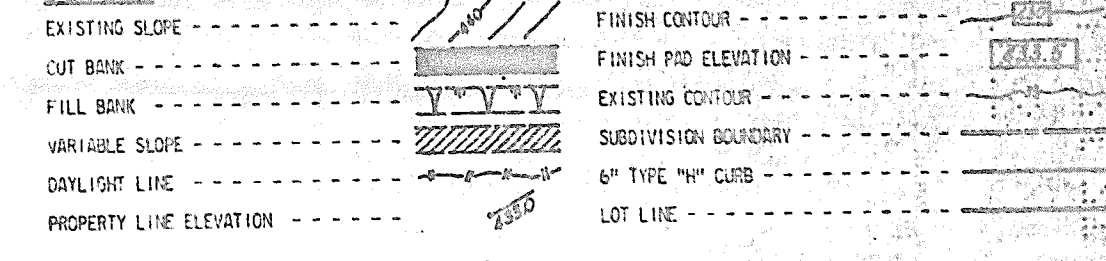

SITE DEVELOPMENT

GRADING AS SHOWN ON THESE PLANS AND IN CONFORMANCE WITH CITY STANDARD DRAWINGS L-43-T, L-44-T, L-45, (DOCUMENT NO. 735691, 4/26/71), CURRENT STANDARD SPECIFICATIONS, AND DIVISION 4, SECTION 62, SAN DIEGO MUNICIPAL CODE. PLANT AND IRRIGATE ALL CUT AND FILL SLOPES AS REQUIRED BY DIVISION 4, SECTION 62, SAN DIEGO MUNICIPAL CODE AND ACCORDING TO CITY ENGINEER'S SPECIFICATIONS FOR LANDSCAPING AND IRRIGATION FOR LAND DEVELOPMENT, DOCUMENT NO. 746399, FILED FEBRUARY 20, 1974.

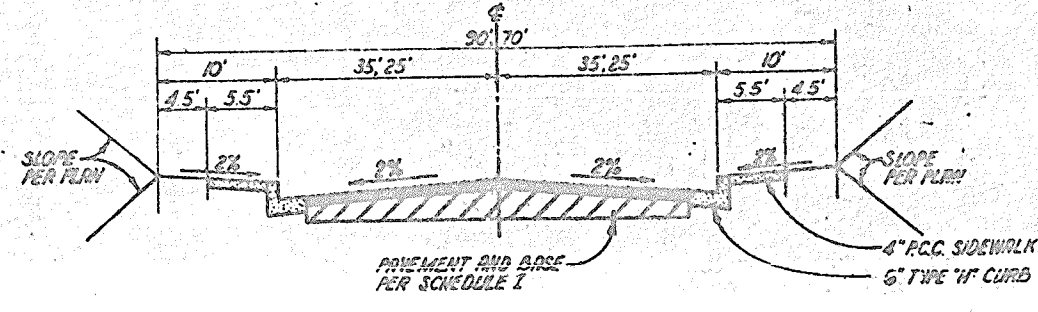

E536745

BENCH MARK
BRASS PLUS AT SOUTH-EAST CORNER
CONWAY STREET AND KEARNY MESA ROAD.
ELEVATION 401.566 M.S.L. DATUM

PRIVATE CONTRACT		DATE 6-10-77
RICK ENGINEERING COMPANY		PROJECT NO. 5707
PLANNING - CIVIL ENGINEERS - LAND SURVEYORS		
1800 FRANKS ROAD SAN DIEGO, CALIFORNIA 92108		TELEPHONE 571-2227
LANDSCAPE PLAN		
KEARNY MESA - DUNN BUSINESS PARK		
UNIT - No. 1		
CITY OF SAN DIEGO, CALIFORNIA		DATE 11-2-77
SHEET 1 OF 3 SHEETS		NO. 106232
BY: R.A. Lusk		DATE: 11-2-77
CHECKED BY: J.W. H. H. H.		
DESCRIPTION		BY
DATE		PLANNED
CONTRACTOR		DATE STARTED
INSPECTOR		DATE COMPLETED
		17416-K-D